

TO LAWRENCE ← MASSACHUSETTS AVENUE. → TO SALEM

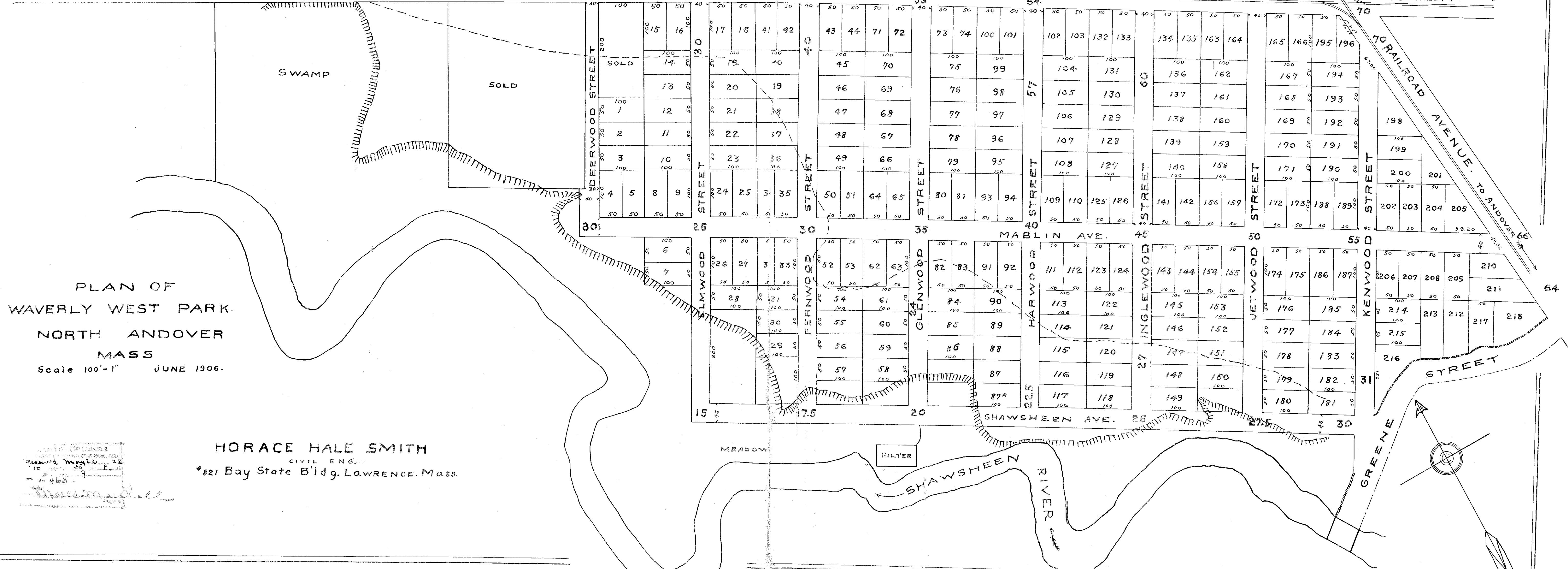

PLAN OF  
 WAVERLY WEST PARK  
 NORTH ANDOVER  
 MASS  
 Scale 100' = 1" JUNE 1906.

HORACE HALE SMITH  
 CIVIL ENG.  
 \*821 Bay State Bldg. LAWRENCE, MASS.

Received May 22 1906  
 No. 463  
*Mass. Marshall*